

B

B

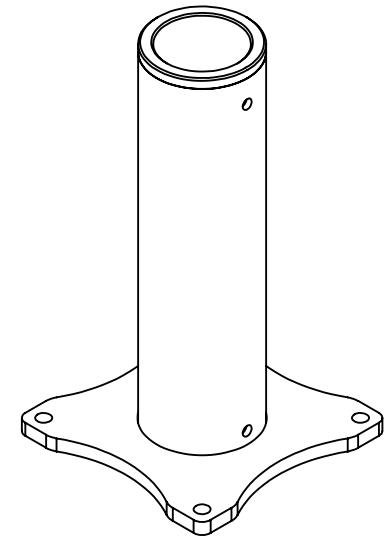
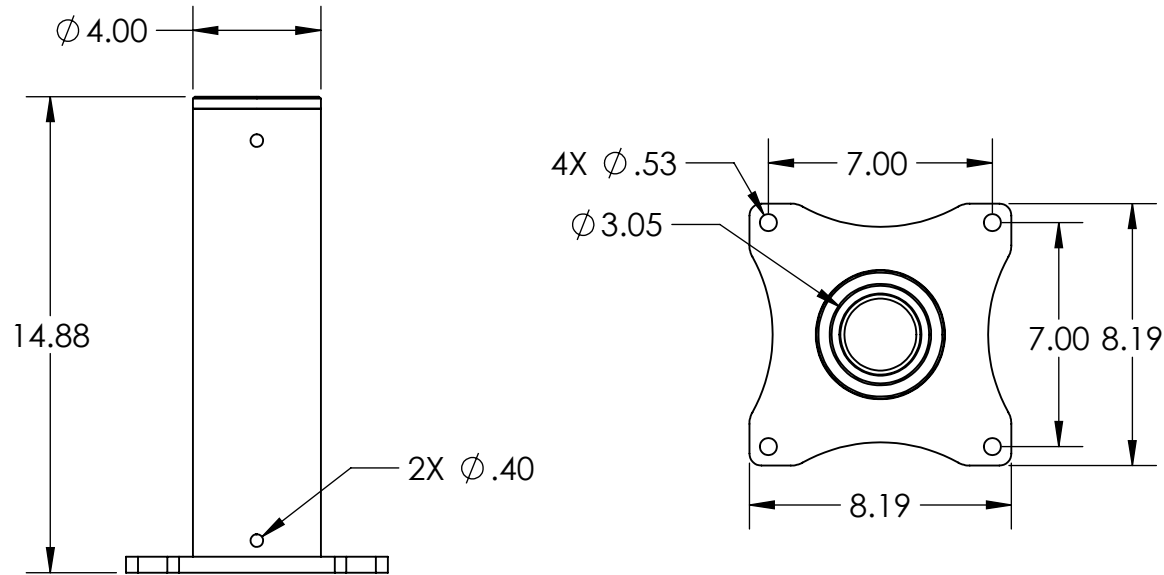

ISOMETRIC VIEW

A

**PROPRIETARY AND CONFIDENTIAL**  
THE INFORMATION CONTAINED IN THIS  
DRAWING IS THE SOLE PROPERTY OF  
OZ LIFTING PRODUCTS. ANY  
REPRODUCTION IN PART OR AS A WHOLE  
WITHOUT THE WRITTEN PERMISSION OF  
OZ LIFTING PRODUCTS IS  
PROHIBITED.

## UNLESS OTHERWISE SPECIFIED:

DIMENSIONS ARE IN INCHES  
TOLERANCES:  
FRACTIONAL  $\pm 1/16$   
ANGULAR: MACH  $\pm 1/2$  degree  
TWO PLACE DECIMAL  $\pm .02$   
THREE PLACE DECIMAL  $\pm .005$

SPECIFIC TOLERANCES TO BE  
CALLED OUT IF NEEDED.

MATERIAL

Assembly

FINISH

OZ Yellow Powdercoat

DO NOT SCALE DRAWING

DRAWN

NAME

JMR

DATE

6/3/2024

CHECKED

ENG APPR.

MFG APPR.

Q.A.

COMMENTS:



TITLE:

500lb PED Base

SIZE

A

Part #

OZPED3

REV

B

SCALE: 1:6

WEIGHT: 20.31

SHEET 2 OF 2

2

1

A