

OZ1BCA-MR



BEAM CLAMP USA

Features

- Fall protection 310 lbs.
- Robust all-steel fully-welded construction
- Super-quick adjustment to most I-Beams (see measurements below)
- ROHS compliant zinc plated finish
- Permanent engraved load rating
- Secondary rod lock nut
- Made in USA
- Individual test certificate & serial number

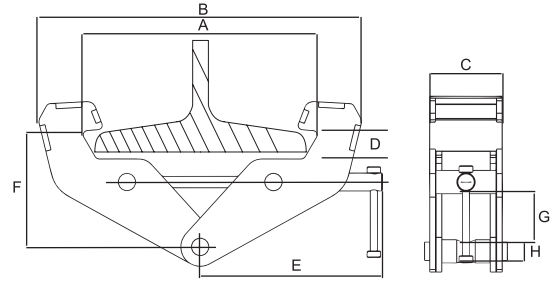

Standards:

This product meets or exceeds OSHA 1926 Subpart M OSHA 1910.140 ASME Z359.1 ASME A10.32-2012 standards for fall protection.

	OZ1BCA-MR	OZ2BCA-MR	OZ3BCA-MR	OZ5BCA-MR	OZ10BCA-MR
Capacity (tons)	1	2	3	5	10
Fall Protection (lbs)	310	310	310	310	310
Dimensional Information (in)	A	3-8	3-8	3.5-13	3.5-13
	B	14.75	14.75	20.5	20.5
	C	2.51	2.91	3.94	4.41
	D	0.9	0.9	1.5	1.5
	E	9.5	9.5	11	11
	F	4.75-5.75	4.75-5.75	7.5-9	7.5-9
	G	1.75	1.75	2.5	2.5
	H	.75	.875	.975	1.125
Net Weight (lbs)	9	11	22	26	39

Dimensions and illustrations are for reference only and subject to change without notice.



OZ1PBTA-MR [PATENTED]

PUSH BEAM TROLLEY USA



Features

- Fall protection 310 lbs.
- Fast and easy width adjustments
- Built-in width adjustment indicator
- Universal wheel tread fits most I, S, and W-Beams
- Premium double-sealed ball bearings
- ROHS compliant zinc plated finish
- Anti-drop plates
- Glow in the dark decals
- Ships fully assembled
- Made in USA
- Individual test certificate & serial number

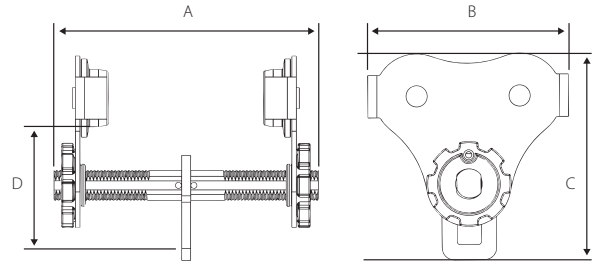

Standards:

This product meets or exceeds OSHA 1926 Subpart M OSHA 1910 ASME Z359.1-2007 ASME A10.32-2012 standards for fall protection.



	OZ05PBTA-MR	OZ05PBTA-MR-12	OZ05PBTA-MR-16	OZ1PBTA-MR	OZ1PBTA-MR-12	OZ1PBTA-MR-16
Capacity (tons)	5	5	5	1	1	1
Adjustable flange width (in)	2.52-8.00	2.52-12.00	2.52-16.00	2.75-8.00	2.75-12.00	2.75-16.00
Max Flange Thickness (in)	1.12	1.12	1.12	1	1	1
Product dimensions	A	12.25	15.5	19.5	15.5	19.5
	B	8.3	8.3	8.3	10.2	10.2
	C	8.5	8.5	8.5	9.8	9.8
	D	5	5	5	5.5	5.5
Minimum radius curve (ft)	2.75	2.75	2.75	3.35	3.35	3.35
Net weight (lbs)	16	19	20	26	30	31

Dimensions and illustrations are for reference only and subject to change without notice.

